

Ground Floor Warehouse Plan

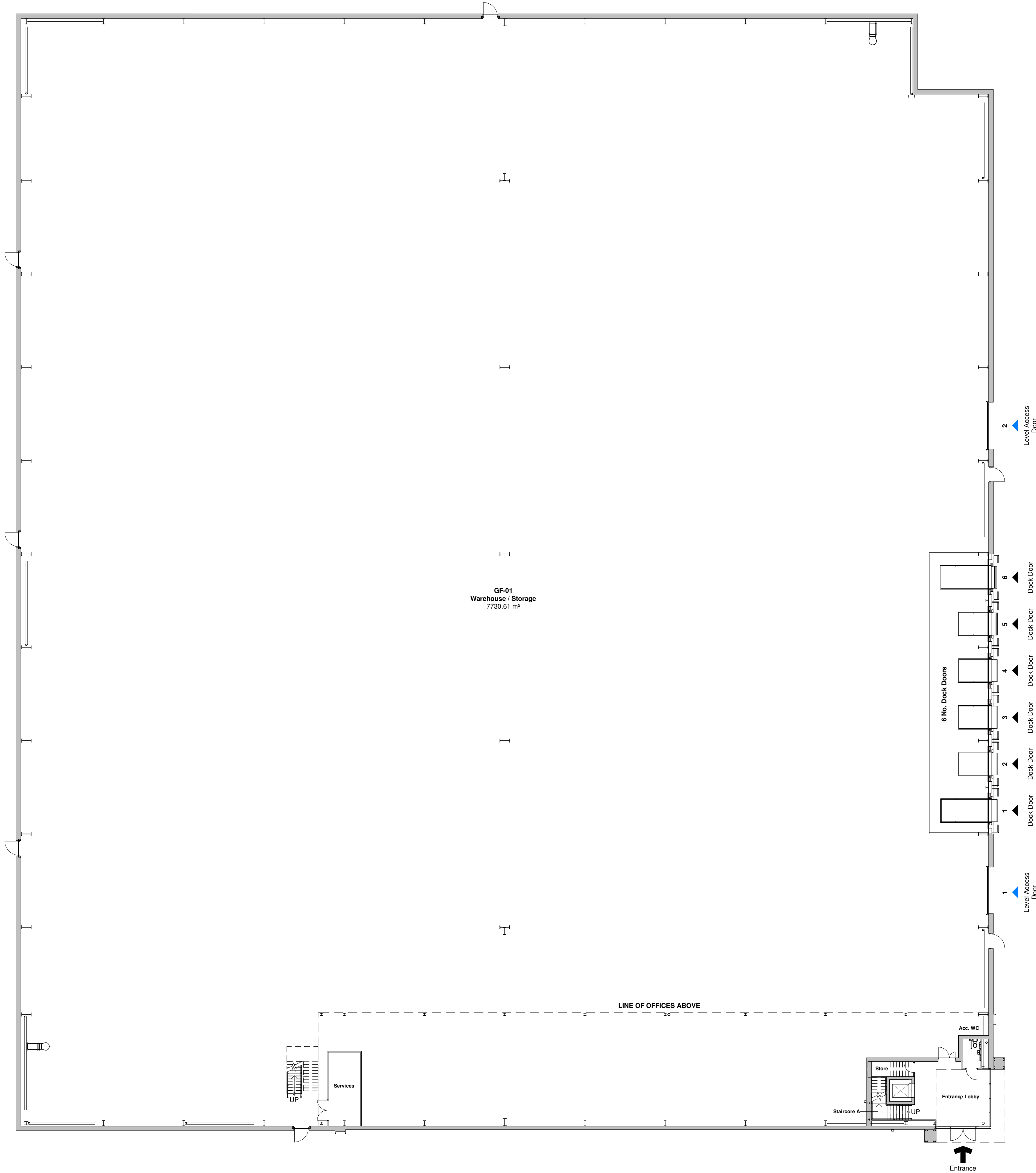

Drawing Status

INFORMATION

This drawing is © C4 Projects and is not to be copied, reproduced or re-distributed either in whole or in part without the prior written permission of the originator.

The originator shall have no responsibility for any liability, loss, cost, damage or expense arising from or relating to any use of this document other than for its intended purpose on this project.

This drawing shall be read in conjunction with all other relevant drawings, specifications and associated documentation. Any discrepancies, errors or omissions are to be reported to the originator before proceeding with work.

All dimensions are to be checked on site by the contractor prior to proceeding with any work. This drawing shall not be scaled to ascertain any dimensions, work to figured dimensions only.

DISCLAIMER
When this drawing is issued in CAD, it is an uncontrolled version issued for information only. To enable the recipient to prepare their own documents/ drawings for which they are solely responsible.

SOFTWARE INTEROPERABILITY
C4 Projects prepared this drawing using Autodesk® REVIT Architecture.

C4 Projects does not accept liability for any loss or degradation of any information held in the drawing resulting from the transition from the original file format to any other file format or from the recipients reading of it in any other programme.

Hazard Identification		
ref	hazard	date

P1	First Issue of Drawing	AH	22.04.24	JC
Rev	Revision Details	Drawn	Date	Checked

C4

Projects

340 Firecrest Court
Quayside,
Centre Park
Warrington
WA1 1RQ
t: 01565 751 852
e: info@c4projects.co.uk
www.c4projects.co.uk

Project Management • Architecture • Building Surveying • Cost Consultancy

Client
BCL (Maple Cross) LLP

Project
Land at Maple Lodge Close,
Maple Cross, Rickmansworth

Drawing Title

Unit 1 Ground Floor Warehouse Plan

Status Purpose of Issue
S2 SUITABLE FOR INFORMATION

Drawn by	AH	Created	APR 24
C4 Job no.	17019	Scale	1 : 200 @ A1

Drg no.	Rev
17019-C4P-U1-00-DR-A-9301	P1